

# MEDICAL SPACE 1,625 SF

## BAY ARBOR PLACE



### Medical space now available – 1,625 square feet

- Ground floor
- Highly visible location on busy Tampa Road in Oldsmar, FL
- Close proximity to East Lake Woodlands and Bay Arbor subdivisions
- Bay Arbor Place features restaurants and retail services on the first floor and professional offices on the second floor
- Join The Melting Pot, SURO Bar & Bistro, Vibe Fit Personal Training & Wellness Center, Tijuana Flats and Whole Aveda Salon & Spa

#### 2009 DEMOGRAPHICS:

1 Mile 3 Miles 5 Miles

	1 Mile	3 Miles	5 Miles
Population (est.)	8,914	55,598	160,010
Total Median Age (in years –est.)	38.26	43.10	44.13
Average Household Income (est.)	\$63,430	\$82,528	\$77,371

#### TRAFFIC COUNT:

61,000 vehicles per day – Tampa Road  
17,232 vehicles per day – Forest Lakes Blvd.  
(Linebaugh extension)

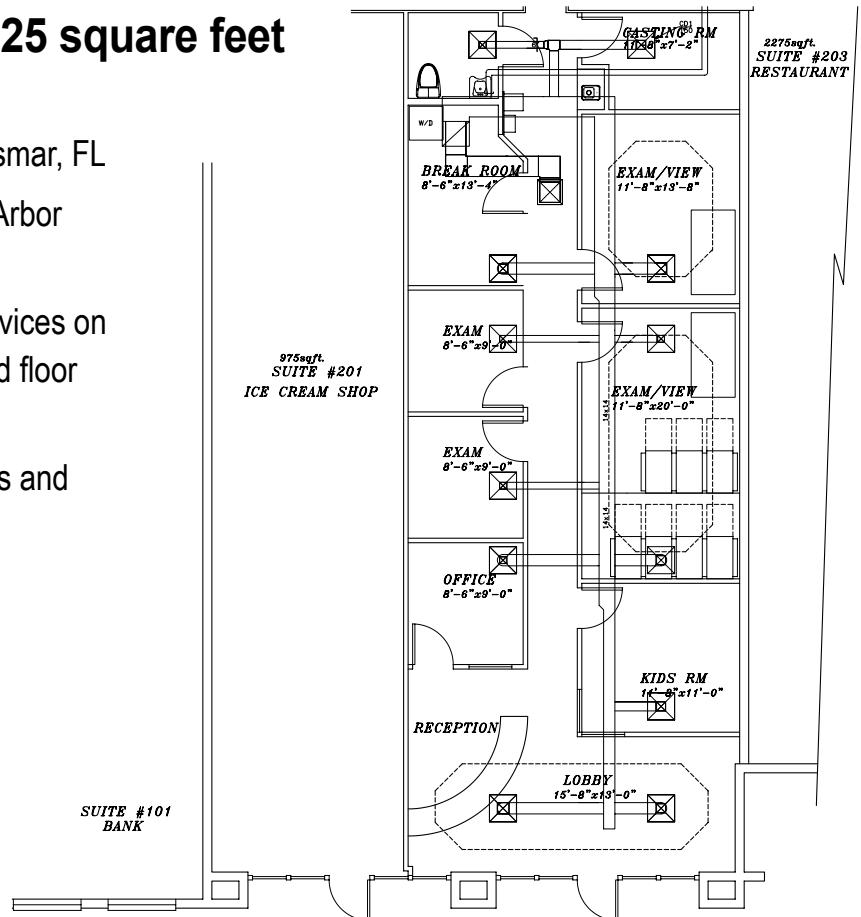

EXCLUSIVELY  
LEASED BY:



**PANTERA**  
RETAIL ADVISORS • INC  
Licensed Real Estate Broker

**WANDA DE BOER**

**813-690-3020**

wanda4re@tampabay.rr.com

www.panteraretail.com

# MEDICAL SPACE 1,625 SF

## BAY ARBOR PLACE



### IDEAL LOCATION

Located directly west of the Linebaugh extension, offering business owners direct access to the affluent Tampa communities of West Chase, Highland Park, Water Chase, and the Eagles. Bay Arbor Place is just east of East Lake Woodlands.

EXCLUSIVELY  
LEASED BY:

**WANDA DE BOER**  
**813-690-3020**  
wanda4re@tampabay.rr.com

#16693999